

## Technical Bulletin: Thermoply Installation

Residential New Construction Program

BUILDING A SMARTER ENERGY FUTURE<sup>SM</sup>

Proper air barrier installation is vital when building a tight home. Homebuilders can use many different types of air barriers, but one of the most popular materials in the RNC Program is Thermoply, also known as T-ply. This technical bulletin will cover instructions for T-ply installation based on the manufacturer's specifications. For a general guideline on air sealing best practices, refer to this [link](#) for the November 2020 technical bulletin.

### Fastening:

When fastening T-ply to a wall, do not fasten the four corners first as demonstrated in the right diagram. This will lead to warping of the T-ply as the framing dries. Instead, follow the pattern and spacing instructions detailed below followed by a diagram to avoid warping.

1. Ensure the T-ply fully covers the wall from the top and bottom. All seams should align with framing members.
2. Add fasteners starting from the top of the stud with a maximum spacing of 6". Button caps are preferred for fasteners, but staplers can be used.
3. After the stud is complete, fasten the top and bottom plates before moving on to the next stud.
4. Start fastening on the next stud and repeat the process.
5. When adding another sheet of T-ply, the sheet should overlap a minimum of  $\frac{3}{4}$ ".

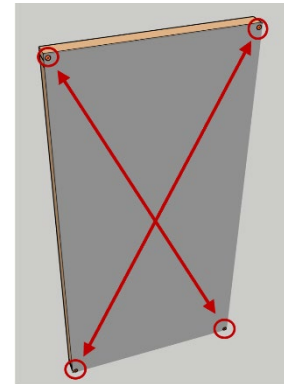

**Incorrect fastening pattern example**

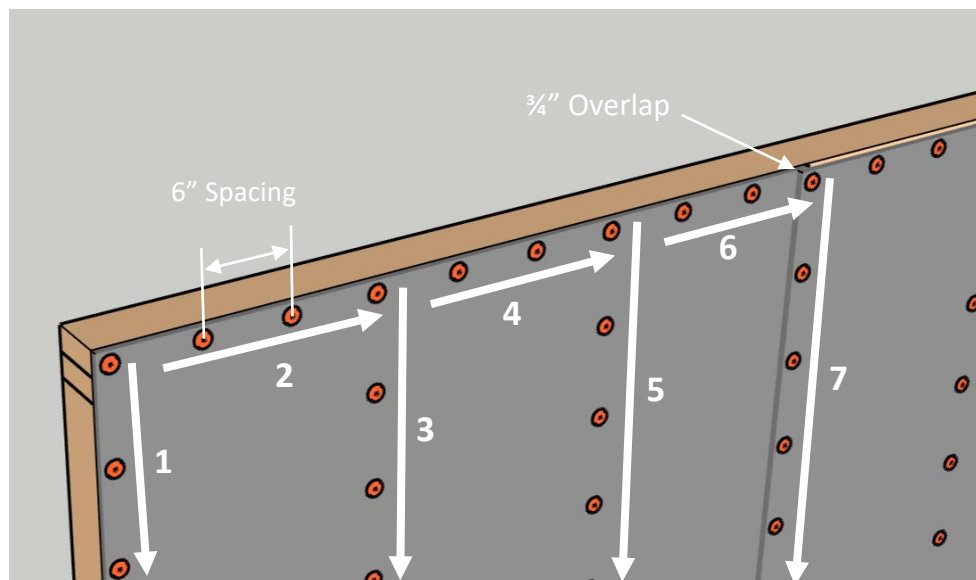

**Diagram depicting the correct fastening instructions**

## **Technical Bulletin: Thermoply Installation**

Residential New Construction Program



BUILDING A *SMARTER* ENERGY FUTURE<sup>SM</sup>

### **Air sealing:**

When air sealing, use the following guidelines for tape and foam.

#### **Tape**

- Use a 2 ½-inch sheathing or construction tape.
- The tape should cover each end of each sheet including seams.
- All fasteners should be covered by tape.

#### **Foam**

- Only use a thin bead of non-expansive window and door foam to prevent warping.
- From the interior side of the wall cavity, picture frame the T-ply to the framing as shown in the below example.
- If the top plates are not continuous, seal the top plate to the studs.

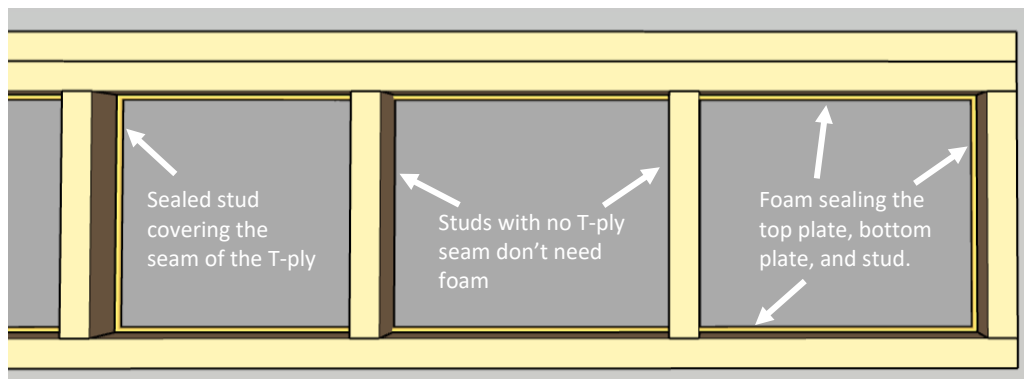

**An example of foam picture framing.**